

THE UNIVERSITY OF
THE SOUTH PACIFIC
SCHOOL OF DISTANCE EDUCATION
SUVA, FIJI
2011

THE UNIVERSITY OF THE SOUTH PACIFIC
SCHOOL OF DISTANCE EDUCATION
SUVA, FIJI
2011

THE UNIVERSITY OF THE SOUTH PACIFIC
SCHOOL OF DISTANCE EDUCATION
SUVA, FIJI

THE UNIVERSITY OF THE SOUTH PACIFIC
SCHOOL OF DISTANCE EDUCATION
SUVA, FIJI

Table 1. Summary of the results of the regression analysis on the determinants of the use of the Internet for health information seeking.

Determinant	Model 1		Model 2		Model 3
	B	SE	B	SE	
Age	-.001	.001	-.001	.001	-.001
Gender	.005	.003	.005	.003	.005
Education	.002	.001	.002	.001	.002
Income	.001	.001	.001	.001	.001
Health status	.003	.002	.003	.002	.003
Health insurance	.001	.001	.001	.001	.001
Health literacy	.005	.002	.005	.002	.005
Health information seeking	.001	.001	.001	.001	.001
Health information needs	.001	.001	.001	.001	.001
Health information sources	.001	.001	.001	.001	.001
Health information use	.001	.001	.001	.001	.001
Health information seeking frequency	.001	.001	.001	.001	.001
Health information seeking duration	.001	.001	.001	.001	.001
Health information seeking satisfaction	.001	.001	.001	.001	.001
Health information seeking self-efficacy	.001	.001	.001	.001	.001
Health information seeking motivation	.001	.001	.001	.001	.001
Health information seeking anxiety	.001	.001	.001	.001	.001
Health information seeking depression	.001	.001	.001	.001	.001
Health information seeking stress	.001	.001	.001	.001	.001
Health information seeking quality of life	.001	.001	.001	.001	.001
Health information seeking health-related quality of life	.001	.001	.001	.001	.001
Health information seeking functional health-related quality of life	.001	.001	.001	.001	.001
Health information seeking emotional health-related quality of life	.001	.001	.001	.001	.001
Health information seeking social health-related quality of life	.001	.001	.001	.001	.001
Health information seeking cognitive health-related quality of life	.001	.001	.001	.001	.001
Health information seeking physical health-related quality of life	.001	.001	.001	.001	.001
Health information seeking mental health-related quality of life	.001	.001	.001	.001	.001
Health information seeking overall health-related quality of life	.001	.001	.001	.001	.001
Health information seeking health-related quality of life (total)	.001	.001	.001	.001	.001
Health information seeking health-related quality of life (physical)	.001	.001	.001	.001	.001
Health information seeking health-related quality of life (mental)	.001	.001	.001	.001	.001
Health information seeking health-related quality of life (social)	.001	.001	.001	.001	.001
Health information seeking health-related quality of life (cognitive)	.001	.001	.001	.001	.001
Health information seeking health-related quality of life (emotional)	.001	.001	.001	.001	.001
Health information seeking health-related quality of life (functional)	.001	.001	.001	.001	.001

Account Name	12/31/11	12/31/12	12/31/13	12/31/14	12/31/15
Accounts Payable	100	100	100	100	100
Accounts Receivable	200	200	200	200	200
Inventory	300	300	300	300	300
Prepaid Expenses	400	400	400	400	400
Property, Plant, and Equipment	500	500	500	500	500
Accumulated Depreciation	(100)	(100)	(100)	(100)	(100)
Accounts Payable	100	100	100	100	100
Accounts Receivable	200	200	200	200	200
Inventory	300	300	300	300	300
Prepaid Expenses	400	400	400	400	400
Property, Plant, and Equipment	500	500	500	500	500
Accumulated Depreciation	(100)	(100)	(100)	(100)	(100)
Accounts Payable	100	100	100	100	100
Accounts Receivable	200	200	200	200	200
Inventory	300	300	300	300	300
Prepaid Expenses	400	400	400	400	400
Property, Plant, and Equipment	500	500	500	500	500
Accumulated Depreciation	(100)	(100)	(100)	(100)	(100)
Accounts Payable	100	100	100	100	100
Accounts Receivable	200	200	200	200	200
Inventory	300	300	300	300	300
Prepaid Expenses	400	400	400	400	400
Property, Plant, and Equipment	500	500	500	500	500
Accumulated Depreciation	(100)	(100)	(100)	(100)	(100)
Accounts Payable	100	100	100	100	100
Accounts Receivable	200	200	200	200	200
Inventory	300	300	300	300	300
Prepaid Expenses	400	400	400	400	400
Property, Plant, and Equipment	500	500	500	500	500
Accumulated Depreciation	(100)	(100)	(100)	(100)	(100)

FUNDING SOURCE		FUNDING TYPE		FUNDING YEAR		FUNDING AMOUNT	
DESCRIPTION	AMOUNT	CATEGORY	START DATE	END DATE	START YEAR	END YEAR	TOTAL AMOUNT
General Fund	100	Operating					
Capital Projects	100	Capital					
Grants	100	Grant					
Special Assessments	100	Special					
State Grants	100	Grant					
Federal Grants	100	Grant					
Local Grants	100	Grant					
Private Foundations	100	Grant					
Corporate Donations	100	Grant					
Individual Donations	100	Grant					
Real Estate	100	Special					
Public Utilities	100	Special					
Governmental	100	Special					
Interagency	100	Special					
Non-Profit	100	Special					
Other	100	Special					
Unassigned	100	Special					
Assigned	100	Special					
Reserve	100	Special					
Contingency	100	Special					
Emergency	100	Special					
Disaster	100	Special					
Other	100	Special					
Unassigned	100	Special					
Assigned	100	Special					
Reserve	100	Special					
Contingency	100	Special					
Emergency	100	Special					
Disaster	100	Special					
Other	100	Special					

Item	Unit	Quantity	Rate	Amount	Total
1. Materials					
a. Direct Materials					
b. Indirect Materials					
2. Manufacturing Overhead					
a. Variable					
b. Fixed					
Total					

Journal Entry
 Debit: Work in Process Inventory
 Credit: Materials Inventory
 Credit: Manufacturing Overhead

Journal Entry
 Debit: Work in Process Inventory
 Credit: Manufacturing Overhead

TABLE 7. (continued) *Contaminant concentrations in sediment*

Station	Sediment		Depth (m)	Sediment		Depth (m)
	Concentration (µg/g)	Concentration (µg/g)		Concentration (µg/g)	Concentration (µg/g)	
1	PCB	150	10	150	10	150
	Dieldrin	10	5	10	5	10
2	PCB	200	15	200	15	200
	Dieldrin	15	10	15	10	15
3	PCB	180	12	180	12	180
	Dieldrin	12	8	12	8	12
4	PCB	160	11	160	11	160
	Dieldrin	11	7	11	7	11
5	PCB	140	9	140	9	140
	Dieldrin	9	6	9	6	9
6	PCB	120	8	120	8	120
	Dieldrin	8	5	8	5	8
7	PCB	100	7	100	7	100
	Dieldrin	7	4	7	4	7
8	PCB	80	6	80	6	80
	Dieldrin	6	3	6	3	6
9	PCB	60	5	60	5	60
	Dieldrin	5	2	5	2	5
10	PCB	40	3	40	3	40
	Dieldrin	3	1	3	1	3
11	PCB	20	1	20	1	20
	Dieldrin	1	0.5	1	0.5	1

Item	Unit	Quantity	Rate	Amount	Remarks
1. Cement	kg	100	100	10000	
2. Sand	kg	100	100	10000	
3. Aggregate	kg	100	100	10000	
4. Labour	kg	100	100	10000	
5. Formwork	kg	100	100	10000	
6. Steel	kg	100	100	10000	
7. Water	kg	100	100	10000	
8. Electricity	kg	100	100	10000	
9. Transport	kg	100	100	10000	
10. Miscellaneous	kg	100	100	10000	
11. Total					
12. Grand Total					

Activity	1990	1991	1992	1993	1994
1. General					
2. Administrative					
3. Financial					
4. Personnel					
5. Legal					
6. Public Affairs					
7. Research and Development					
8. Technical Services					
9. Training					
10. Other					
11. Unallocated					
12. Total					
13. Change from 1990					
14. Percentage Change					
15. Comments					

1. General Information Name: _____ Address: _____ City: _____ State: _____ Zip: _____					
2. Subject Name: _____ Address: _____ City: _____ State: _____ Zip: _____					
3. Parent Name: _____ Address: _____ City: _____ State: _____ Zip: _____					
4. Teacher Name: _____ Address: _____ City: _____ State: _____ Zip: _____					
5. Other Name: _____ Address: _____ City: _____ State: _____ Zip: _____					
6. Comments _____					
7. Signature _____					
8. Date _____					
9. Remarks _____					
10. Signature _____					
11. Date _____					
12. Remarks _____					
13. Signature _____					
14. Date _____					
15. Remarks _____					
16. Signature _____					
17. Date _____					
18. Remarks _____					
19. Signature _____					
20. Date _____					
21. Remarks _____					
22. Signature _____					
23. Date _____					
24. Remarks _____					
25. Signature _____					
26. Date _____					
27. Remarks _____					
28. Signature _____					
29. Date _____					
30. Remarks _____					
31. Signature _____					
32. Date _____					
33. Remarks _____					
34. Signature _____					
35. Date _____					
36. Remarks _____					
37. Signature _____					
38. Date _____					
39. Remarks _____					
40. Signature _____					
41. Date _____					
42. Remarks _____					
43. Signature _____					
44. Date _____					
45. Remarks _____					
46. Signature _____					
47. Date _____					
48. Remarks _____					
49. Signature _____					
50. Date _____					
51. Remarks _____					
52. Signature _____					
53. Date _____					
54. Remarks _____					
55. Signature _____					
56. Date _____					
57. Remarks _____					
58. Signature _____					
59. Date _____					
60. Remarks _____					
61. Signature _____					
62. Date _____					
63. Remarks _____					
64. Signature _____					
65. Date _____					
66. Remarks _____					
67. Signature _____					
68. Date _____					
69. Remarks _____					
70. Signature _____					
71. Date _____					
72. Remarks _____					
73. Signature _____					
74. Date _____					
75. Remarks _____					
76. Signature _____					
77. Date _____					
78. Remarks _____					
79. Signature _____					
80. Date _____					
81. Remarks _____					
82. Signature _____					
83. Date _____					
84. Remarks _____					
85. Signature _____					
86. Date _____					
87. Remarks _____					
88. Signature _____					
89. Date _____					
90. Remarks _____					
91. Signature _____					
92. Date _____					
93. Remarks _____					
94. Signature _____					
95. Date _____					
96. Remarks _____					
97. Signature _____					
98. Date _____					
99. Remarks _____					
100. Signature _____					
101. Date _____					
102. Remarks _____					
103. Signature _____					
104. Date _____					
105. Remarks _____					
106. Signature _____					
107. Date _____					
108. Remarks _____					
109. Signature _____					
110. Date _____					
111. Remarks _____					
112. Signature _____					
113. Date _____					
114. Remarks _____					
115. Signature _____					
116. Date _____					
117. Remarks _____					
118. Signature _____					
119. Date _____					
120. Remarks _____					
121. Signature _____					
122. Date _____					
123. Remarks _____					
124. Signature _____					
125. Date _____					
126. Remarks _____					
127. Signature _____					
128. Date _____					
129. Remarks _____					
130. Signature _____					
131. Date _____					
132. Remarks _____					
133. Signature _____					
134. Date _____					
135. Remarks _____					
136. Signature _____					
137. Date _____					
138. Remarks _____					
139. Signature _____					
140. Date _____					
141. Remarks _____					
142. Signature _____					
143. Date _____					
144. Remarks _____					
145. Signature _____					
146. Date _____					
147. Remarks _____					
148. Signature _____					
149. Date _____					
150. Remarks _____					

Item	Unit	Quantity	Rate	Amount	Remarks
1. Cement	kg	100	100	100	
2. Sand	kg	100	100	100	
3. Aggregate	kg	100	100	100	
4. Water	kg	100	100	100	
5. Labor	kg	100	100	100	
6. Formwork	kg	100	100	100	
7. Steel	kg	100	100	100	
8. Admixture	kg	100	100	100	
9. Pigment	kg	100	100	100	
10. Plasticizer	kg	100	100	100	
11. Accelerator	kg	100	100	100	
12. Retarder	kg	100	100	100	
13. Air Entrainment	kg	100	100	100	
14. Corrosion Inhibitor	kg	100	100	100	
15. Shrinkage Reducer	kg	100	100	100	
16. Self-Consolidating	kg	100	100	100	
17. High-Strength	kg	100	100	100	
18. Low-Water	kg	100	100	100	
19. High-Durability	kg	100	100	100	
20. Sulfate Resistant	kg	100	100	100	
21. Chloride Resistant	kg	100	100	100	
22. Freeze-Thaw Resistant	kg	100	100	100	
23. High-Temperature	kg	100	100	100	
24. Low-Temperature	kg	100	100	100	
25. High-Strength Concrete	kg	100	100	100	
26. Low-Water Concrete	kg	100	100	100	
27. High-Durability Concrete	kg	100	100	100	
28. Sulfate Resistant Concrete	kg	100	100	100	
29. Chloride Resistant Concrete	kg	100	100	100	
30. Freeze-Thaw Resistant Concrete	kg	100	100	100	
31. High-Temperature Concrete	kg	100	100	100	
32. Low-Temperature Concrete	kg	100	100	100	
33. High-Strength Concrete	kg	100	100	100	
34. Low-Water Concrete	kg	100	100	100	
35. High-Durability Concrete	kg	100	100	100	
36. Sulfate Resistant Concrete	kg	100	100	100	
37. Chloride Resistant Concrete	kg	100	100	100	
38. Freeze-Thaw Resistant Concrete	kg	100	100	100	
39. High-Temperature Concrete	kg	100	100	100	
40. Low-Temperature Concrete	kg	100	100	100	
41. High-Strength Concrete	kg	100	100	100	
42. Low-Water Concrete	kg	100	100	100	
43. High-Durability Concrete	kg	100	100	100	
44. Sulfate Resistant Concrete	kg	100	100	100	
45. Chloride Resistant Concrete	kg	100	100	100	
46. Freeze-Thaw Resistant Concrete	kg	100	100	100	
47. High-Temperature Concrete	kg	100	100	100	
48. Low-Temperature Concrete	kg	100	100	100	
49. High-Strength Concrete	kg	100	100	100	
50. Low-Water Concrete	kg	100	100	100	
51. High-Durability Concrete	kg	100	100	100	
52. Sulfate Resistant Concrete	kg	100	100	100	
53. Chloride Resistant Concrete	kg	100	100	100	
54. Freeze-Thaw Resistant Concrete	kg	100	100	100	
55. High-Temperature Concrete	kg	100	100	100	
56. Low-Temperature Concrete	kg	100	100	100	
57. High-Strength Concrete	kg	100	100	100	
58. Low-Water Concrete	kg	100	100	100	
59. High-Durability Concrete	kg	100	100	100	
60. Sulfate Resistant Concrete	kg	100	100	100	
61. Chloride Resistant Concrete	kg	100	100	100	
62. Freeze-Thaw Resistant Concrete	kg	100	100	100	
63. High-Temperature Concrete	kg	100	100	100	
64. Low-Temperature Concrete	kg	100	100	100	
65. High-Strength Concrete	kg	100	100	100	
66. Low-Water Concrete	kg	100	100	100	
67. High-Durability Concrete	kg	100	100	100	
68. Sulfate Resistant Concrete	kg	100	100	100	
69. Chloride Resistant Concrete	kg	100	100	100	
70. Freeze-Thaw Resistant Concrete	kg	100	100	100	
71. High-Temperature Concrete	kg	100	100	100	
72. Low-Temperature Concrete	kg	100	100	100	
73. High-Strength Concrete	kg	100	100	100	
74. Low-Water Concrete	kg	100	100	100	
75. High-Durability Concrete	kg	100	100	100	
76. Sulfate Resistant Concrete	kg	100	100	100	
77. Chloride Resistant Concrete	kg	100	100	100	
78. Freeze-Thaw Resistant Concrete	kg	100	100	100	
79. High-Temperature Concrete	kg	100	100	100	
80. Low-Temperature Concrete	kg	100	100	100	
81. High-Strength Concrete	kg	100	100	100	
82. Low-Water Concrete	kg	100	100	100	
83. High-Durability Concrete	kg	100	100	100	
84. Sulfate Resistant Concrete	kg	100	100	100	
85. Chloride Resistant Concrete	kg	100	100	100	
86. Freeze-Thaw Resistant Concrete	kg	100	100	100	
87. High-Temperature Concrete	kg	100	100	100	
88. Low-Temperature Concrete	kg	100	100	100	
89. High-Strength Concrete	kg	100	100	100	
90. Low-Water Concrete	kg	100	100	100	
91. High-Durability Concrete	kg	100	100	100	
92. Sulfate Resistant Concrete	kg	100	100	100	
93. Chloride Resistant Concrete	kg	100	100	100	
94. Freeze-Thaw Resistant Concrete	kg	100	100	100	
95. High-Temperature Concrete	kg	100	100	100	
96. Low-Temperature Concrete	kg	100	100	100	
97. High-Strength Concrete	kg	100	100	100	
98. Low-Water Concrete	kg	100	100	100	
99. High-Durability Concrete	kg	100	100	100	
100. Sulfate Resistant Concrete	kg	100	100	100	

Year	2000	2001	2002	2003	2004	2005	2006	2007	2008	2009	2010	2011	2012	2013	2014	2015	2016	2017	2018	2019	2020	2021	2022	2023	2024	2025	2026	2027	2028	2029	2030																																																																																																																																																																																																																																																																																																																																																																																																																																																																																																																																																																																																																																																																																																																																																																																																																																																																																																						
Population	100	101	102	103	104	105	106	107	108	109	110	111	112	113	114	115	116	117	118	119	120	121	122	123	124	125	126	127	128	129	130	131	132	133	134	135	136	137	138	139	140	141	142	143	144	145	146	147	148	149	150	151	152	153	154	155	156	157	158	159	160	161	162	163	164	165	166	167	168	169	170	171	172	173	174	175	176	177	178	179	180	181	182	183	184	185	186	187	188	189	190	191	192	193	194	195	196	197	198	199	200	201	202	203	204	205	206	207	208	209	210	211	212	213	214	215	216	217	218	219	220	221	222	223	224	225	226	227	228	229	230	231	232	233	234	235	236	237	238	239	240	241	242	243	244	245	246	247	248	249	250	251	252	253	254	255	256	257	258	259	260	261	262	263	264	265	266	267	268	269	270	271	272	273	274	275	276	277	278	279	280	281	282	283	284	285	286	287	288	289	290	291	292	293	294	295	296	297	298	299	300	301	302	303	304	305	306	307	308	309	310	311	312	313	314	315	316	317	318	319	320	321	322	323	324	325	326	327	328	329	330	331	332	333	334	335	336	337	338	339	340	341	342	343	344	345	346	347	348	349	350	351	352	353	354	355	356	357	358	359	360	361	362	363	364	365	366	367	368	369	370	371	372	373	374	375	376	377	378	379	380	381	382	383	384	385	386	387	388	389	390	391	392	393	394	395	396	397	398	399	400	401	402	403	404	405	406	407	408	409	410	411	412	413	414	415	416	417	418	419	420	421	422	423	424	425	426	427	428	429	430	431	432	433	434	435	436	437	438	439	440	441	442	443	444	445	446	447	448	449	450	451	452	453	454	455	456	457	458	459	460	461	462	463	464	465	466	467	468	469	470	471	472	473	474	475	476	477	478	479	480	481	482	483	484	485	486	487	488	489	490	491	492	493	494	495	496	497	498	499	500	501	502	503	504	505	506	507	508	509	510	511	512	513	514	515	516	517	518	519	520	521	522	523	524	525	526	527	528	529	530	531	532	533	534	535	536	537	538	539	540	541	542	543	544	545	546	547	548	549	550	551	552	553	554	555	556	557	558	559	560	561	562	563	564	565	566	567	568	569	570	571	572	573	574	575	576	577	578	579	580	581	582	583	584	585	586	587	588	589	590	591	592	593	594	595	596	597	598	599	600	601	602	603	604	605	606	607	608	609	610	611	612	613	614	615	616	617	618	619	620	621	622	623	624	625	626	627	628	629	630	631	632	633	634	635	636	637	638	639	640	641	642	643	644	645	646	647	648	649	650	651	652	653	654	655	656	657	658	659	660	661	662	663	664	665	666	667	668	669	670	671	672	673	674	675	676	677	678	679	680	681	682	683	684	685	686	687	688	689	690	691	692	693	694	695	696	697	698	699	700	701	702	703	704	705	706	707	708	709	710	711	712	713	714	715	716	717	718	719	720	721	722	723	724	725	726	727	728	729	730	731	732	733	734	735	736	737	738	739	740	741	742	743	744	745	746	747	748	749	750	751	752	753	754	755	756	757	758	759	760	761	762	763	764	765	766	767	768	769	770	771	772	773	774	775	776	777	778	779	780	781	782	783	784	785	786	787	788	789	790	791	792	793	794	795	796	797	798	799	800	801	802	803	804	805	806	807	808	809	810	811	812	813	814	815	816	817	818	819	820	821	822	823	824	825	826	827	828	829	830	831	832	833	834	835	836	837	838	839	840	841	842	843	844	845	846	847	848	849	850	851	852	853	854	855	856	857	858	859	860	861	862	863	864	865	866	867	868	869	870	871	872	873	874	875	876	877	878	879	880	881	882	883	884	885	886	887	888	889	890	891	892	893	894	895	896	897	898	899	900	901	902	903	904	905	906	907	908	909	910	911	912	913	914	915	916	917	918	919	920	921	922	923	924	925	926	927	928	929	930	931	932	933	934	935	936	937	938	939	940	941	942	943	944	945	946	947	948	949	950	951	952	953	954	955	956	957	958	959	960	961	962	963	964	965	966	967	968	969	970	971	972	973	974	975	976	977	978	979	980	981	982	983	984	985	986	987	988	989	990	991	992	993	994	995	996	997	998	999	1000

The following table shows the population growth rate for the period 2000-2025. The population growth rate is calculated as the percentage change in population over the period. The population growth rate is positive for all years from 2000 to 2025, indicating that the population is growing. The population growth rate is highest in 2000 and lowest in 2025.

The following table shows the population growth rate for the period 2000-2025. The population growth rate is calculated as the percentage change in population over the period. The population growth rate is positive for all years from 2000 to 2025, indicating that the population is growing. The population growth rate is highest in 2000 and lowest in 2025.

Item	Unit	Quantity	Rate	Amount
1.
2.
3.
4.
5.
6.
7.
8.
9.
10.
11.
12.
13.
14.
15.
16.
17.
18.
19.
20.
21.
22.
23.
24.
25.
26.
27.
28.
29.
30.
31.
32.
33.
34.
35.
36.
37.
38.
39.
40.
41.
42.
43.
44.
45.
46.
47.
48.
49.
50.
51.
52.
53.
54.
55.
56.
57.
58.
59.
60.
61.
62.
63.
64.
65.
66.
67.
68.
69.
70.
71.
72.
73.
74.
75.
76.
77.
78.
79.
80.
81.
82.
83.
84.
85.
86.
87.
88.
89.
90.
91.
92.
93.
94.
95.
96.
97.
98.
99.
100.

Year	1990	1991	1992	1993	1994
1990	100	100	100	100	100
1991	100	100	100	100	100
1992	100	100	100	100	100
1993	100	100	100	100	100
1994	100	100	100	100	100
1995	100	100	100	100	100
1996	100	100	100	100	100
1997	100	100	100	100	100
1998	100	100	100	100	100
1999	100	100	100	100	100
2000	100	100	100	100	100
2001	100	100	100	100	100
2002	100	100	100	100	100
2003	100	100	100	100	100
2004	100	100	100	100	100
2005	100	100	100	100	100
2006	100	100	100	100	100
2007	100	100	100	100	100
2008	100	100	100	100	100
2009	100	100	100	100	100
2010	100	100	100	100	100
2011	100	100	100	100	100
2012	100	100	100	100	100
2013	100	100	100	100	100
2014	100	100	100	100	100
2015	100	100	100	100	100
2016	100	100	100	100	100
2017	100	100	100	100	100
2018	100	100	100	100	100
2019	100	100	100	100	100
2020	100	100	100	100	100
2021	100	100	100	100	100
2022	100	100	100	100	100
2023	100	100	100	100	100
2024	100	100	100	100	100
2025	100	100	100	100	100
2026	100	100	100	100	100
2027	100	100	100	100	100
2028	100	100	100	100	100
2029	100	100	100	100	100
2030	100	100	100	100	100

Date	Time	Location	Weather	Temperature	Remarks
1/1/20	08:00
1/1/20	09:00
1/1/20	10:00
1/1/20	11:00
1/1/20	12:00
1/1/20	13:00
1/1/20	14:00
1/1/20	15:00
1/1/20	16:00
1/1/20	17:00
1/1/20	18:00
1/1/20	19:00
1/1/20	20:00
1/1/20	21:00
1/1/20	22:00
1/1/20	23:00
1/2/20	00:00
1/2/20	01:00
1/2/20	02:00
1/2/20	03:00
1/2/20	04:00
1/2/20	05:00
1/2/20	06:00
1/2/20	07:00
1/2/20	08:00
1/2/20	09:00
1/2/20	10:00
1/2/20	11:00
1/2/20	12:00
1/2/20	13:00
1/2/20	14:00
1/2/20	15:00
1/2/20	16:00
1/2/20	17:00
1/2/20	18:00
1/2/20	19:00
1/2/20	20:00
1/2/20	21:00
1/2/20	22:00
1/2/20	23:00
2/2/20	00:00
2/2/20	01:00
2/2/20	02:00
2/2/20	03:00
2/2/20	04:00
2/2/20	05:00
2/2/20	06:00
2/2/20	07:00
2/2/20	08:00
2/2/20	09:00
2/2/20	10:00
2/2/20	11:00
2/2/20	12:00
2/2/20	13:00
2/2/20	14:00
2/2/20	15:00
2/2/20	16:00
2/2/20	17:00
2/2/20	18:00
2/2/20	19:00
2/2/20	20:00
2/2/20	21:00
2/2/20	22:00
2/2/20	23:00

Year	1980	1981	1982	1983
1. Total population	100	100	100	100
2. Total population in urban areas	30	35	40	45
3. Total population in rural areas	70	65	60	55
4. Total population in metropolitan areas	15	18	22	28
5. Total population in suburban areas	15	17	18	17
6. Total population in rural areas	55	47	38	27
7. Total population in small towns	35	47	52	53
8. Total population in villages	20	18	16	14
9. Total population in hamlets	5	5	5	5
10. Total population in isolated dwellings	5	5	5	5
11. Total population in urban areas	30	35	40	45
12. Total population in rural areas	70	65	60	55
13. Total population in metropolitan areas	15	18	22	28
14. Total population in suburban areas	15	17	18	17
15. Total population in rural areas	55	47	38	27
16. Total population in small towns	35	47	52	53
17. Total population in villages	20	18	16	14
18. Total population in hamlets	5	5	5	5
19. Total population in isolated dwellings	5	5	5	5
20. Total population in urban areas	30	35	40	45
21. Total population in rural areas	70	65	60	55
22. Total population in metropolitan areas	15	18	22	28
23. Total population in suburban areas	15	17	18	17
24. Total population in rural areas	55	47	38	27
25. Total population in small towns	35	47	52	53
26. Total population in villages	20	18	16	14
27. Total population in hamlets	5	5	5	5
28. Total population in isolated dwellings	5	5	5	5

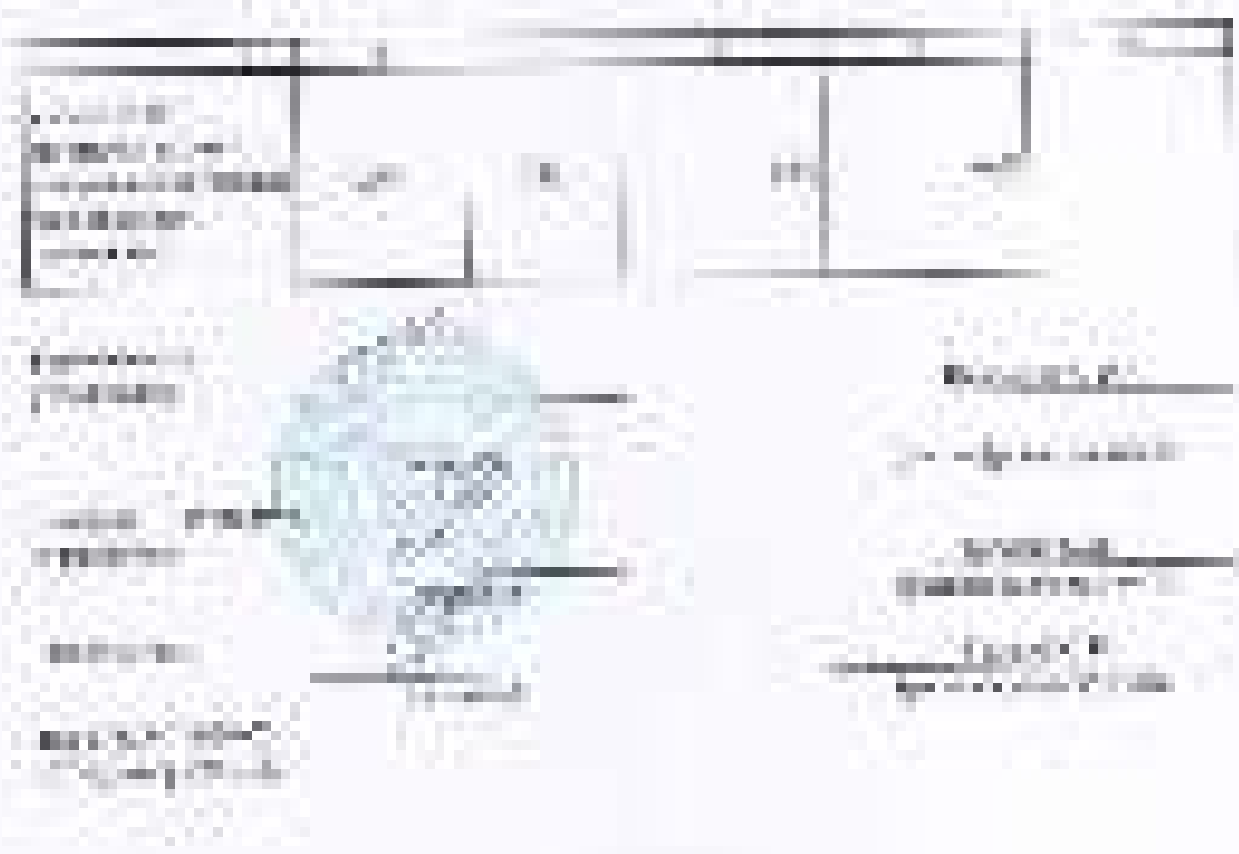

Activity	1	2	3	4	5
1. Review of the previous lesson	10	10	10	10	10
2. Introduction of the new lesson	10	10	10	10	10
3. Presentation of the new lesson	10	10	10	10	10
4. Practice of the new lesson	10	10	10	10	10
5. Summary of the new lesson	10	10	10	10	10
6. Homework assignment	10	10	10	10	10
7. Evaluation of the lesson	10	10	10	10	10
8. Reflection on the lesson	10	10	10	10	10
9. Conclusion of the lesson	10	10	10	10	10
10. Final remarks	10	10	10	10	10

TABLE 1					
SUMMARY OF THE DATA					
Year	1990	1991	1992	1993	1994
1. Total population	100	100	100	100	100
2. Total population	100	100	100	100	100
3. Total population	100	100	100	100	100
4. Total population	100	100	100	100	100
5. Total population	100	100	100	100	100
6. Total population	100	100	100	100	100
7. Total population	100	100	100	100	100
8. Total population	100	100	100	100	100
9. Total population	100	100	100	100	100
10. Total population	100	100	100	100	100
11. Total population	100	100	100	100	100
12. Total population	100	100	100	100	100
13. Total population	100	100	100	100	100
14. Total population	100	100	100	100	100
15. Total population	100	100	100	100	100
16. Total population	100	100	100	100	100
17. Total population	100	100	100	100	100
18. Total population	100	100	100	100	100
19. Total population	100	100	100	100	100
20. Total population	100	100	100	100	100
21. Total population	100	100	100	100	100
22. Total population	100	100	100	100	100
23. Total population	100	100	100	100	100
24. Total population	100	100	100	100	100
25. Total population	100	100	100	100	100
26. Total population	100	100	100	100	100
27. Total population	100	100	100	100	100
28. Total population	100	100	100	100	100
29. Total population	100	100	100	100	100
30. Total population	100	100	100	100	100
31. Total population	100	100	100	100	100
32. Total population	100	100	100	100	100
33. Total population	100	100	100	100	100
34. Total population	100	100	100	100	100
35. Total population	100	100	100	100	100
36. Total population	100	100	100	100	100
37. Total population	100	100	100	100	100
38. Total population	100	100	100	100	100
39. Total population	100	100	100	100	100
40. Total population	100	100	100	100	100
41. Total population	100	100	100	100	100
42. Total population	100	100	100	100	100
43. Total population	100	100	100	100	100
44. Total population	100	100	100	100	100
45. Total population	100	100	100	100	100
46. Total population	100	100	100	100	100
47. Total population	100	100	100	100	100
48. Total population	100	100	100	100	100
49. Total population	100	100	100	100	100
50. Total population	100	100	100	100	100

<p>1. The following are the main components of the system:</p> <ul style="list-style-type: none"> Hardware Software Network Security 	<p>2. The system is designed to provide a secure and reliable environment for the user.</p>	<p>3. The system is designed to provide a secure and reliable environment for the user.</p>	<p>4. The system is designed to provide a secure and reliable environment for the user.</p>
--	---	---	---

5. The system is designed to provide a secure and reliable environment for the user.

6. The system is designed to provide a secure and reliable environment for the user.

7. The system is designed to provide a secure and reliable environment for the user.

8. The system is designed to provide a secure and reliable environment for the user.

9. The system is designed to provide a secure and reliable environment for the user.

10. The system is designed to provide a secure and reliable environment for the user.

11. The system is designed to provide a secure and reliable environment for the user.

12. The system is designed to provide a secure and reliable environment for the user.

13. The system is designed to provide a secure and reliable environment for the user.

14. The system is designed to provide a secure and reliable environment for the user.

15. The system is designed to provide a secure and reliable environment for the user.

Date	Time	Location	Weather	Observations			
				Temperature	Humidity	Wind	Other
10/15/2023	08:00	Central Park	Clear	65°F	45%	10 mph	Light breeze
10/15/2023	12:00	Central Park	Clear	72°F	55%	12 mph	Light breeze
10/15/2023	05:00	Central Park	Clear	58°F	40%	8 mph	Light breeze
10/15/2023	09:00	Central Park	Clear	68°F	50%	10 mph	Light breeze
10/15/2023	14:00	Central Park	Clear	75°F	60%	15 mph	Light breeze
10/15/2023	17:00	Central Park	Clear	70°F	55%	12 mph	Light breeze
10/15/2023	20:00	Central Park	Clear	62°F	45%	10 mph	Light breeze
10/15/2023	23:00	Central Park	Clear	55°F	40%	8 mph	Light breeze
10/16/2023	08:00	Central Park	Clear	65°F	45%	10 mph	Light breeze
10/16/2023	12:00	Central Park	Clear	72°F	55%	12 mph	Light breeze
10/16/2023	05:00	Central Park	Clear	58°F	40%	8 mph	Light breeze
10/16/2023	09:00	Central Park	Clear	68°F	50%	10 mph	Light breeze
10/16/2023	14:00	Central Park	Clear	75°F	60%	15 mph	Light breeze
10/16/2023	17:00	Central Park	Clear	70°F	55%	12 mph	Light breeze
10/16/2023	20:00	Central Park	Clear	62°F	45%	10 mph	Light breeze
10/16/2023	23:00	Central Park	Clear	55°F	40%	8 mph	Light breeze
10/17/2023	08:00	Central Park	Clear	65°F	45%	10 mph	Light breeze
10/17/2023	12:00	Central Park	Clear	72°F	55%	12 mph	Light breeze
10/17/2023	05:00	Central Park	Clear	58°F	40%	8 mph	Light breeze
10/17/2023	09:00	Central Park	Clear	68°F	50%	10 mph	Light breeze
10/17/2023	14:00	Central Park	Clear	75°F	60%	15 mph	Light breeze
10/17/2023	17:00	Central Park	Clear	70°F	55%	12 mph	Light breeze
10/17/2023	20:00	Central Park	Clear	62°F	45%	10 mph	Light breeze
10/17/2023	23:00	Central Park	Clear	55°F	40%	8 mph	Light breeze

Sl. No.	Name of the Candidate	Grade	Section	Roll No.	Mark	Percentage	Remarks
1							
2							
3							
4							
5							
6							
7							
8							
9							
10							
11							
12							
13							
14							
15							
16							
17							
18							
19							
20							
21							
22							
23							
24							
25							
26							
27							
28							
29							
30							
31							
32							
33							
34							
35							
36							
37							
38							
39							
40							
41							
42							
43							
44							
45							
46							
47							
48							
49							
50							
51							
52							
53							
54							
55							
56							
57							
58							
59							
60							
61							
62							
63							
64							
65							
66							
67							
68							
69							
70							
71							
72							
73							
74							
75							
76							
77							
78							
79							
80							
81							
82							
83							
84							
85							
86							
87							
88							
89							
90							
91							
92							
93							
94							
95							
96							
97							
98							
99							
100							

Date	Time	Location	Activity	Observations				
				1	2	3	4	5
10/10/2023	08:00	Field Station	Sample Collection	1	2	3	4	5
10/10/2023	09:00	Field Station	Sample Collection	1	2	3	4	5
10/10/2023	10:00	Field Station	Sample Collection	1	2	3	4	5
10/10/2023	11:00	Field Station	Sample Collection	1	2	3	4	5
10/10/2023	12:00	Field Station	Sample Collection	1	2	3	4	5
10/10/2023	13:00	Field Station	Sample Collection	1	2	3	4	5
10/10/2023	14:00	Field Station	Sample Collection	1	2	3	4	5
10/10/2023	15:00	Field Station	Sample Collection	1	2	3	4	5
10/10/2023	16:00	Field Station	Sample Collection	1	2	3	4	5
10/10/2023	17:00	Field Station	Sample Collection	1	2	3	4	5
10/10/2023	18:00	Field Station	Sample Collection	1	2	3	4	5
10/10/2023	19:00	Field Station	Sample Collection	1	2	3	4	5
10/10/2023	20:00	Field Station	Sample Collection	1	2	3	4	5
10/10/2023	21:00	Field Station	Sample Collection	1	2	3	4	5
10/10/2023	22:00	Field Station	Sample Collection	1	2	3	4	5
10/10/2023	23:00	Field Station	Sample Collection	1	2	3	4	5

Sl. No.	Name of the Candidate	Grade	Section	Roll No.	Mark	Grade	Section	Roll No.	Mark
1	A. A. A.	A	A	1	100	A	A	1	100
2	B. B. B.	B	B	2	90	B	B	2	90
3	C. C. C.	C	C	3	80	C	C	3	80
4	D. D. D.	D	D	4	70	D	D	4	70
5	E. E. E.	E	E	5	60	E	E	5	60
6	F. F. F.	F	F	6	50	F	F	6	50
7	G. G. G.	G	G	7	40	G	G	7	40
8	H. H. H.	H	H	8	30	H	H	8	30
9	I. I. I.	I	I	9	20	I	I	9	20
10	J. J. J.	J	J	10	10	J	J	10	10

		1		2		3		4		5		6		7		8		9		10	
1	2	3	4	5	6	7	8	9	10	11	12	13	14	15	16	17	18	19	20	21	22
23	24	25	26	27	28	29	30	31	32	33	34	35	36	37	38	39	40	41	42	43	44
45	46	47	48	49	50	51	52	53	54	55	56	57	58	59	60	61	62	63	64	65	66
67	68	69	70	71	72	73	74	75	76	77	78	79	80	81	82	83	84	85	86	87	88
89	90	91	92	93	94	95	96	97	98	99	100	101	102	103	104	105	106	107	108	109	110
111	112	113	114	115	116	117	118	119	120	121	122	123	124	125	126	127	128	129	130	131	132
133	134	135	136	137	138	139	140	141	142	143	144	145	146	147	148	149	150	151	152	153	154
155	156	157	158	159	160	161	162	163	164	165	166	167	168	169	170	171	172	173	174	175	176
177	178	179	180	181	182	183	184	185	186	187	188	189	190	191	192	193	194	195	196	197	198
199	200	201	202	203	204	205	206	207	208	209	210	211	212	213	214	215	216	217	218	219	220
221	222	223	224	225	226	227	228	229	230	231	232	233	234	235	236	237	238	239	240	241	242
243	244	245	246	247	248	249	250	251	252	253	254	255	256	257	258	259	260	261	262	263	264
265	266	267	268	269	270	271	272	273	274	275	276	277	278	279	280	281	282	283	284	285	286
287	288	289	290	291	292	293	294	295	296	297	298	299	300	301	302	303	304	305	306	307	308
309	310	311	312	313	314	315	316	317	318	319	320	321	322	323	324	325	326	327	328	329	330
331	332	333	334	335	336	337	338	339	340	341	342	343	344	345	346	347	348	349	350	351	352
353	354	355	356	357	358	359	360	361	362	363	364	365	366	367	368	369	370	371	372	373	374
375	376	377	378	379	380	381	382	383	384	385	386	387	388	389	390	391	392	393	394	395	396
397	398	399	400	401	402	403	404	405	406	407	408	409	410	411	412	413	414	415	416	417	418
419	420	421	422	423	424	425	426	427	428	429	430	431	432	433	434	435	436	437	438	439	440
441	442	443	444	445	446	447	448	449	450	451	452	453	454	455	456	457	458	459	460	461	462
463	464	465	466	467	468	469	470	471	472	473	474	475	476	477	478	479	480	481	482	483	484
485	486	487	488	489	490	491	492	493	494	495	496	497	498	499	500	501	502	503	504	505	506
507	508	509	510	511	512	513	514	515	516	517	518	519	520	521	522	523	524	525	526	527	528
529	530	531	532	533	534	535	536	537	538	539	540	541	542	543	544	545	546	547	548	549	550
551	552	553	554	555	556	557	558	559	560	561	562	563	564	565	566	567	568	569	570	571	572
573	574	575	576	577	578	579	580	581	582	583	584	585	586	587	588	589	590	591	592	593	594
595	596	597	598	599	600	601	602	603	604	605	606	607	608	609	610	611	612	613	614	615	616
617	618	619	620	621	622	623	624	625	626	627	628	629	630	631	632	633	634	635	636	637	638
639	640	641	642	643	644	645	646	647	648	649	650	651	652	653	654	655	656	657	658	659	660
661	662	663	664	665	666	667	668	669	670	671	672	673	674	675	676	677	678	679	680	681	682
683	684	685	686	687	688	689	690	691	692	693	694	695	696	697	698	699	700	701	702	703	704
705	706	707	708	709	710	711	712	713	714	715	716	717	718	719	720	721	722	723	724	725	726
727	728	729	730	731	732	733	734	735	736	737	738	739	740	741	742	743	744	745	746	747	748
749	750	751	752	753	754	755	756	757	758	759	760	761	762	763	764	765	766	767	768	769	770
771	772	773	774	775	776	777	778	779	780	781	782	783	784	785	786	787	788	789	790	791	792
793	794	795	796	797	798	799	800	801	802	803	804	805	806	807	808	809	810	811	812	813	814
815	816	817	818	819	820	821	822	823	824	825	826	827	828	829	830	831	832	833	834	835	836
837	838	839	840	841	842	843	844	845	846	847	848	849	850	851	852	853	854	855	856	857	858
859	860	861	862	863	864	865	866	867	868	869	870	871	872	873	874	875	876	877	878	879	880
881	882	883	884	885	886	887	888	889	890	891	892	893	894	895	896	897	898	899	900	901	902
903	904	905	906	907	908	909	910	911	912	913	914	915	916	917	918	919	920	921	922	923	924
925	926	927	928	929	930	931	932	933	934	935	936	937	938	939	940	941	942	943	944	945	946
947	948	949	950	951	952	953	954	955	956	957	958	959	960	961	962	963	964	965	966	967	968
969	970	971	972	973	974	975	976	977	978	979	980	981	982	983	984	985	986	987	988	989	990
991	992	993	994	995	996	997	998	999	1000	1001	1002	1003	1004	1005	1006	1007	1008	1009	1010	1011	1012

Date	Time	Location	Activity	Temperature (°C)			Remarks
				Surface	Mid-depth	Bottom	
10/10/2023	08:00	Station 1	Water sampling	18.5	15.0	12.0	Clear water, blue sky
10/10/2023	12:00	Station 2	Water sampling	22.0	18.0	14.0	Light breeze, calm sea
10/10/2023	16:00	Station 3	Water sampling	20.0	16.0	13.0	Increasing cloud cover
10/10/2023	20:00	Station 4	Water sampling	19.0	15.0	12.0	Light rain starting
10/10/2023	00:00	Station 5	Water sampling	17.0	14.0	11.0	Heavy rain, dark clouds
10/10/2023	04:00	Station 6	Water sampling	15.0	12.0	10.0	Thunder, strong wind
10/10/2023	08:00	Station 7	Water sampling	16.0	13.0	11.0	Clearing, light rain
10/10/2023	12:00	Station 8	Water sampling	18.0	15.0	12.0	Partly cloudy
10/10/2023	16:00	Station 9	Water sampling	20.0	17.0	14.0	Breeze picking up
10/10/2023	20:00	Station 10	Water sampling	21.0	18.0	15.0	Clear, calm
10/10/2023	00:00	Station 11	Water sampling	20.0	17.0	14.0	Light moon, clear
10/10/2023	04:00	Station 12	Water sampling	18.0	15.0	12.0	Clear, cool
10/10/2023	08:00	Station 13	Water sampling	19.0	16.0	13.0	Light breeze
10/10/2023	12:00	Station 14	Water sampling	21.0	18.0	15.0	Clear, warm
10/10/2023	16:00	Station 15	Water sampling	22.0	19.0	16.0	Light breeze, clear
10/10/2023	20:00	Station 16	Water sampling	21.0	18.0	15.0	Clear, calm
10/10/2023	00:00	Station 17	Water sampling	20.0	17.0	14.0	Clear, cool
10/10/2023	04:00	Station 18	Water sampling	18.0	15.0	12.0	Clear, calm
10/10/2023	08:00	Station 19	Water sampling	19.0	16.0	13.0	Light breeze
10/10/2023	12:00	Station 20	Water sampling	21.0	18.0	15.0	Clear, warm
10/10/2023	16:00	Station 21	Water sampling	22.0	19.0	16.0	Light breeze, clear
10/10/2023	20:00	Station 22	Water sampling	21.0	18.0	15.0	Clear, calm
10/10/2023	00:00	Station 23	Water sampling	20.0	17.0	14.0	Clear, cool
10/10/2023	04:00	Station 24	Water sampling	18.0	15.0	12.0	Clear, calm
10/10/2023	08:00	Station 25	Water sampling	19.0	16.0	13.0	Light breeze
10/10/2023	12:00	Station 26	Water sampling	21.0	18.0	15.0	Clear, warm
10/10/2023	16:00	Station 27	Water sampling	22.0	19.0	16.0	Light breeze, clear
10/10/2023	20:00	Station 28	Water sampling	21.0	18.0	15.0	Clear, calm
10/10/2023	00:00	Station 29	Water sampling	20.0	17.0	14.0	Clear, cool
10/10/2023	04:00	Station 30	Water sampling	18.0	15.0	12.0	Clear, calm

Date	Particulars	Rs.	
		Paise	Cent
1900			
1901			
1902			
1903			
1904			
1905			
1906			
1907			
1908			
1909			
1910			
1911			
1912			
1913			
1914			
1915			
1916			
1917			
1918			
1919			
1920			
1921			
1922			
1923			
1924			
1925			
1926			
1927			
1928			
1929			
1930			
1931			
1932			
1933			
1934			
1935			
1936			
1937			
1938			
1939			
1940			
1941			
1942			
1943			
1944			
1945			
1946			
1947			
1948			
1949			
1950			
1951			
1952			
1953			
1954			
1955			
1956			
1957			
1958			
1959			
1960			
1961			
1962			
1963			
1964			
1965			
1966			
1967			
1968			
1969			
1970			
1971			
1972			
1973			
1974			
1975			
1976			
1977			
1978			
1979			
1980			
1981			
1982			
1983			
1984			
1985			
1986			
1987			
1988			
1989			
1990			
1991			
1992			
1993			
1994			
1995			
1996			
1997			
1998			
1999			
2000			
2001			
2002			
2003			
2004			
2005			
2006			
2007			
2008			
2009			
2010			
2011			
2012			
2013			
2014			
2015			
2016			
2017			
2018			
2019			
2020			
2021			
2022			
2023			
2024			
2025			
2026			
2027			
2028			
2029			
2030			
2031			
2032			
2033			
2034			
2035			
2036			
2037			
2038			
2039			
2040			
2041			
2042			
2043			
2044			
2045			
2046			
2047			
2048			
2049			
2050			
2051			
2052			
2053			
2054			
2055			
2056			
2057			
2058			
2059			
2060			
2061			
2062			
2063			
2064			
2065			
2066			
2067			
2068			
2069			
2070			
2071			
2072			
2073			
2074			
2075			
2076			
2077			
2078			
2079			
2080			
2081			
2082			
2083			
2084			
2085			
2086			
2087			
2088			
2089			
2090			
2091			
2092			
2093			
2094			
2095			
2096			
2097			
2098			
2099			
2100			

1. 1900
 2. 1901
 3. 1902
 4. 1903
 5. 1904
 6. 1905
 7. 1906
 8. 1907
 9. 1908
 10. 1909
 11. 1910
 12. 1911
 13. 1912
 14. 1913
 15. 1914
 16. 1915
 17. 1916
 18. 1917
 19. 1918
 20. 1919
 21. 1920
 22. 1921
 23. 1922
 24. 1923
 25. 1924
 26. 1925
 27. 1926
 28. 1927
 29. 1928
 30. 1929
 31. 1930
 32. 1931
 33. 1932
 34. 1933
 35. 1934
 36. 1935
 37. 1936
 38. 1937
 39. 1938
 40. 1939
 41. 1940
 42. 1941
 43. 1942
 44. 1943
 45. 1944
 46. 1945
 47. 1946
 48. 1947
 49. 1948
 50. 1949
 51. 1950
 52. 1951
 53. 1952
 54. 1953
 55. 1954
 56. 1955
 57. 1956
 58. 1957
 59. 1958
 60. 1959
 61. 1960
 62. 1961
 63. 1962
 64. 1963
 65. 1964
 66. 1965
 67. 1966
 68. 1967
 69. 1968
 70. 1969
 71. 1970
 72. 1971
 73. 1972
 74. 1973
 75. 1974
 76. 1975
 77. 1976
 78. 1977
 79. 1978
 80. 1979
 81. 1980
 82. 1981
 83. 1982
 84. 1983
 85. 1984
 86. 1985
 87. 1986
 88. 1987
 89. 1988
 90. 1989
 91. 1990
 92. 1991
 93. 1992
 94. 1993
 95. 1994
 96. 1995
 97. 1996
 98. 1997
 99. 1998
 100. 1999
 101. 2000
 102. 2001
 103. 2002
 104. 2003
 105. 2004
 106. 2005
 107. 2006
 108. 2007
 109. 2008
 110. 2009
 111. 2010
 112. 2011
 113. 2012
 114. 2013
 115. 2014
 116. 2015
 117. 2016
 118. 2017
 119. 2018
 120. 2019
 121. 2020
 122. 2021
 123. 2022
 124. 2023
 125. 2024
 126. 2025
 127. 2026
 128. 2027
 129. 2028
 130. 2029
 131. 2030
 132. 2031
 133. 2032
 134. 2033
 135. 2034
 136. 2035
 137. 2036
 138. 2037
 139. 2038
 140. 2039
 141. 2040
 142. 2041
 143. 2042
 144. 2043
 145. 2044
 146. 2045
 147. 2046
 148. 2047
 149. 2048
 150. 2049
 151. 2050
 152. 2051
 153. 2052
 154. 2053
 155. 2054
 156. 2055
 157. 2056
 158. 2057
 159. 2058
 160. 2059
 161. 2060
 162. 2061
 163. 2062
 164. 2063
 165. 2064
 166. 2065
 167. 2066
 168. 2067
 169. 2068
 170. 2069
 171. 2070
 172. 2071
 173. 2072
 174. 2073
 175. 2074
 176. 2075
 177. 2076
 178. 2077
 179. 2078
 180. 2079
 181. 2080
 182. 2081
 183. 2082
 184. 2083
 185. 2084
 186. 2085
 187. 2086
 188. 2087
 189. 2088
 190. 2089
 191. 2090
 192. 2091
 193. 2092
 194. 2093
 195. 2094
 196. 2095
 197. 2096
 198. 2097
 199. 2098
 200. 2099
 201. 2100

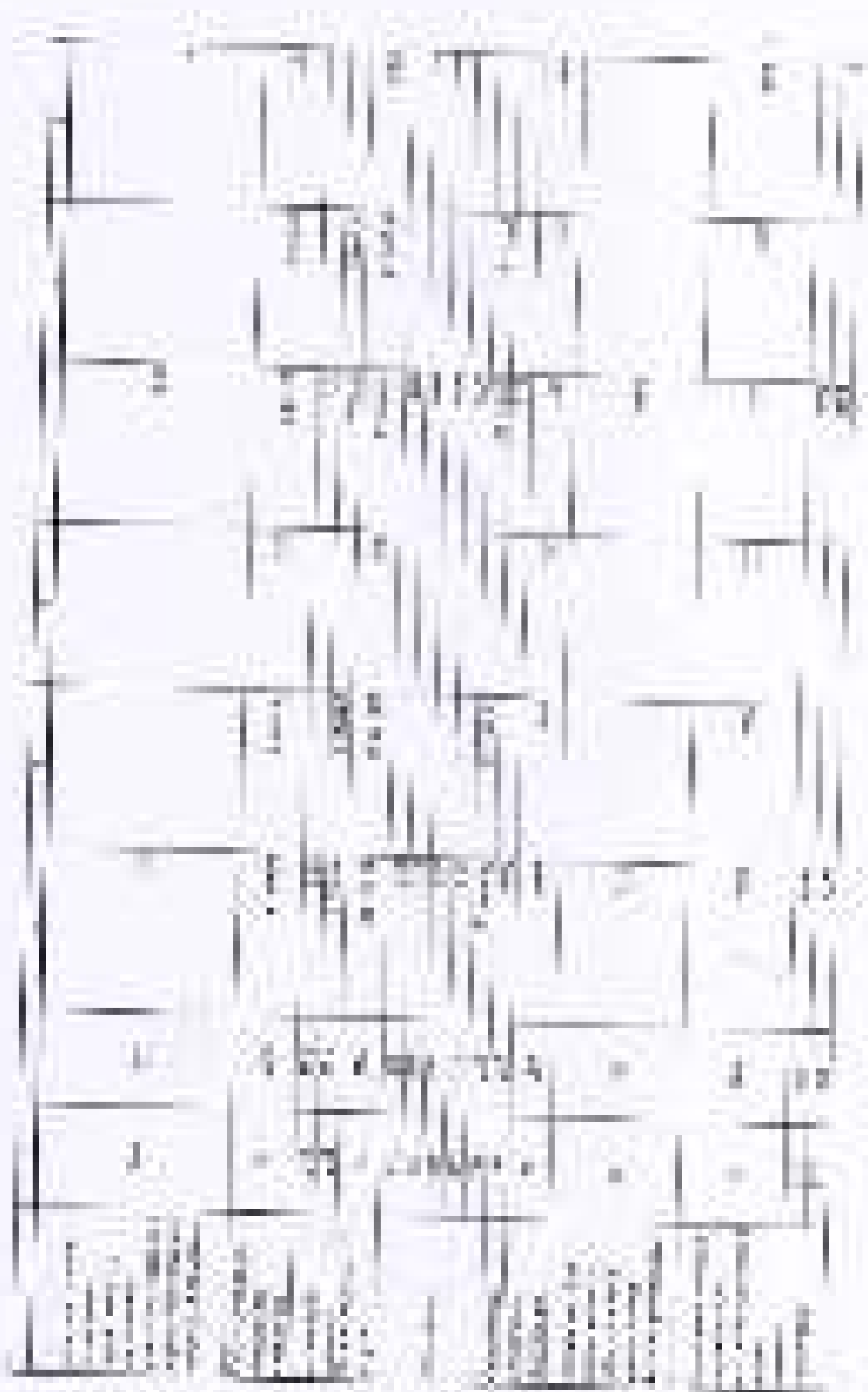

	1	2	3	4
1				
2				
3				
4				
5				
6				
7				

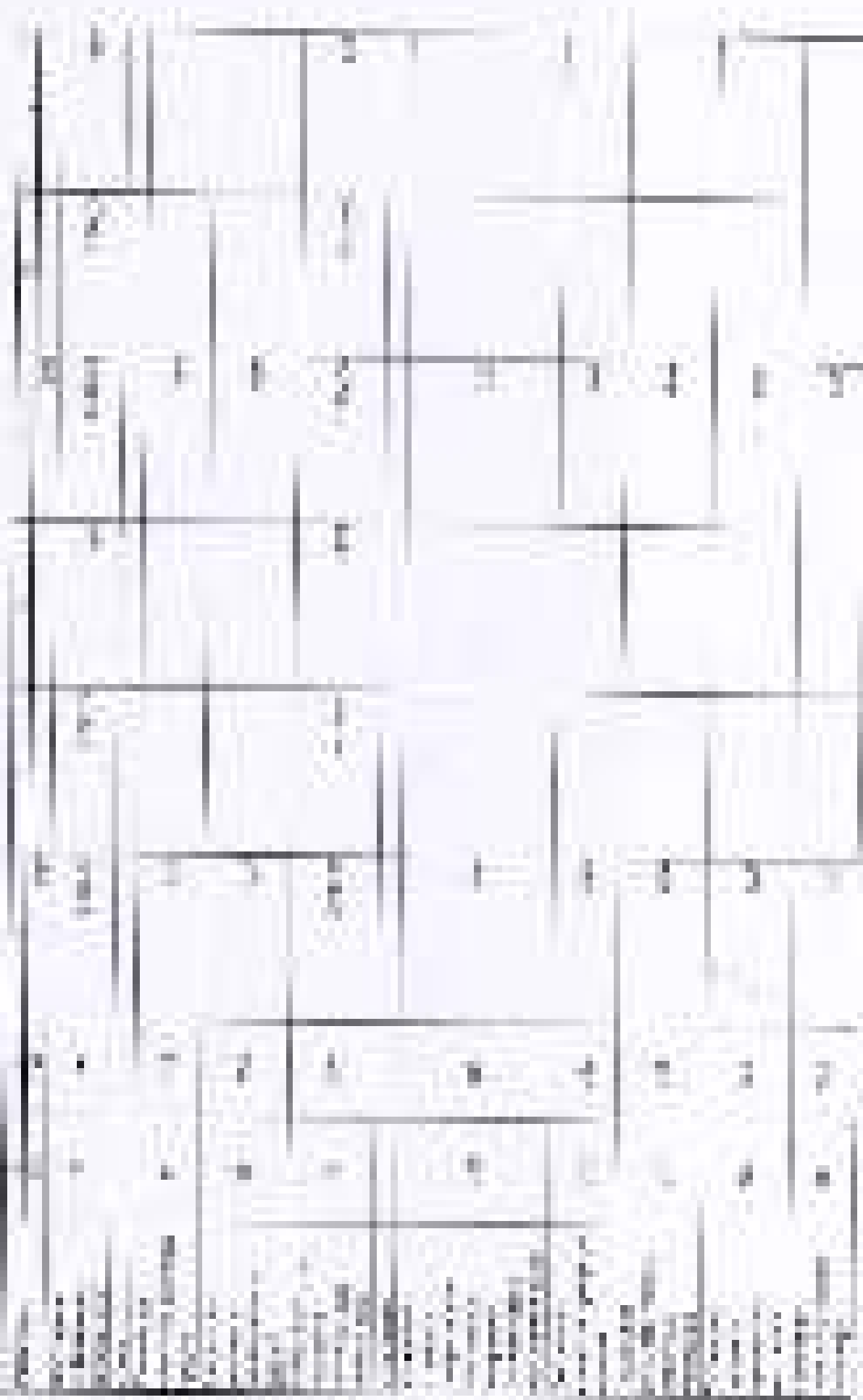

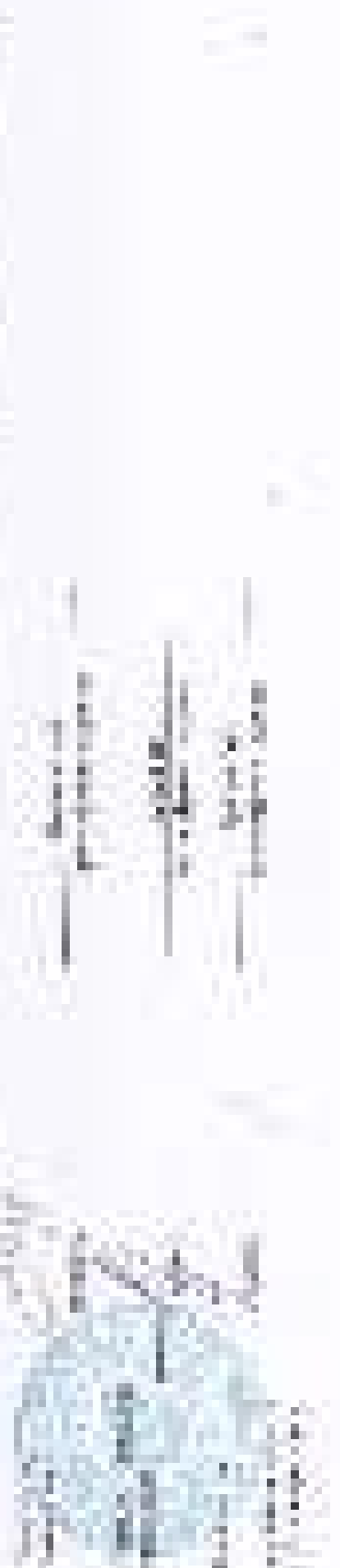
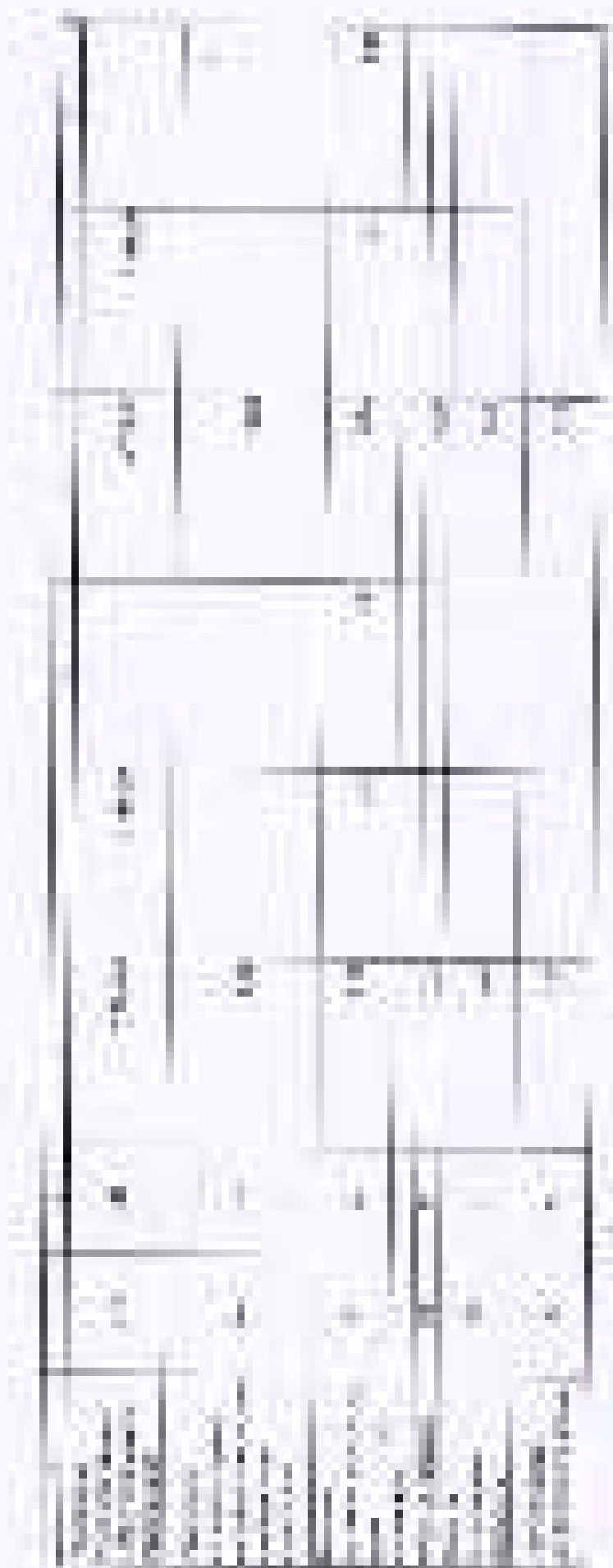

Technical drawing with various annotations and labels, including dimensions and reference markers.

1	2	3	4	5	6	7	8
9	10	11	12	13	14	15	16
17	18	19	20	21	22	23	24
25	26	27	28	29	30	31	32
33	34	35	36	37	38	39	40
41	42	43	44	45	46	47	48
49	50	51	52	53	54	55	56
57	58	59	60	61	62	63	64
65	66	67	68	69	70	71	72
73	74	75	76	77	78	79	80
81	82	83	84	85	86	87	88
89	90	91	92	93	94	95	96
97	98	99	100	101	102	103	104
105	106	107	108	109	110	111	112
113	114	115	116	117	118	119	120
121	122	123	124	125	126	127	128
129	130	131	132	133	134	135	136
137	138	139	140	141	142	143	144
145	146	147	148	149	150	151	152
153	154	155	156	157	158	159	160
161	162	163	164	165	166	167	168
169	170	171	172	173	174	175	176
177	178	179	180	181	182	183	184
185	186	187	188	189	190	191	192
193	194	195	196	197	198	199	200
201	202	203	204	205	206	207	208
209	210	211	212	213	214	215	216
217	218	219	220	221	222	223	224
225	226	227	228	229	230	231	232
233	234	235	236	237	238	239	240
241	242	243	244	245	246	247	248
249	250	251	252	253	254	255	256
257	258	259	260	261	262	263	264
265	266	267	268	269	270	271	272
273	274	275	276	277	278	279	280
281	282	283	284	285	286	287	288
289	290	291	292	293	294	295	296
297	298	299	300	301	302	303	304
305	306	307	308	309	310	311	312
313	314	315	316	317	318	319	320
321	322	323	324	325	326	327	328
329	330	331	332	333	334	335	336
337	338	339	340	341	342	343	344
345	346	347	348	349	350	351	352
353	354	355	356	357	358	359	360
361	362	363	364	365	366	367	368
369	370	371	372	373	374	375	376
377	378	379	380	381	382	383	384
385	386	387	388	389	390	391	392
393	394	395	396	397	398	399	400
401	402	403	404	405	406	407	408
409	410	411	412	413	414	415	416
417	418	419	420	421	422	423	424
425	426	427	428	429	430	431	432
433	434	435	436	437	438	439	440
441	442	443	444	445	446	447	448
449	450	451	452	453	454	455	456
457	458	459	460	461	462	463	464
465	466	467	468	469	470	471	472
473	474	475	476	477	478	479	480
481	482	483	484	485	486	487	488
489	490	491	492	493	494	495	496
497	498	499	500	501	502	503	504
505	506	507	508	509	510	511	512
513	514	515	516	517	518	519	520
521	522	523	524	525	526	527	528
529	530	531	532	533	534	535	536
537	538	539	540	541	542	543	544
545	546	547	548	549	550	551	552
553	554	555	556	557	558	559	560
561	562	563	564	565	566	567	568
569	570	571	572	573	574	575	576
577	578	579	580	581	582	583	584
585	586	587	588	589	590	591	592
593	594	595	596	597	598	599	600
601	602	603	604	605	606	607	608
609	610	611	612	613	614	615	616
617	618	619	620	621	622	623	624
625	626	627	628	629	630	631	632
633	634	635	636	637	638	639	640
641	642	643	644	645	646	647	648
649	650	651	652	653	654	655	656
657	658	659	660	661	662	663	664
665	666	667	668	669	670	671	672
673	674	675	676	677	678	679	680
681	682	683	684	685	686	687	688
689	690	691	692	693	694	695	696
697	698	699	700	701	702	703	704
705	706	707	708	709	710	711	712
713	714	715	716	717	718	719	720
721	722	723	724	725	726	727	728
729	730	731	732	733	734	735	736
737	738	739	740	741	742	743	744
745	746	747	748	749	750	751	752
753	754	755	756	757	758	759	760
761	762	763	764	765	766	767	768
769	770	771	772	773	774	775	776
777	778	779	780	781	782	783	784
785	786	787	788	789	790	791	792
793	794	795	796	797	798	799	800
801	802	803	804	805	806	807	808
809	810	811	812	813	814	815	816
817	818	819	820	821	822	823	824
825	826	827	828	829	830	831	832
833	834	835	836	837	838	839	840
841	842	843	844	845	846	847	848
849	850	851	852	853	854	855	856
857	858	859	860	861	862	863	864
865	866	867	868	869	870	871	872
873	874	875	876	877	878	879	880
881	882	883	884	885	886	887	888
889	890	891	892	893	894	895	896
897	898	899	900	901	902	903	904
905	906	907	908	909	910	911	912
913	914	915	916	917	918	919	920
921	922	923	924	925	926	927	928
929	930	931	932	933	934	935	936
937	938	939	940	941	942	943	944
945	946	947	948	949	950	951	952
953	954	955	956	957	958	959	960
961	962	963	964	965	966	967	968
969	970	971	972	973	974	975	976
977	978	979	980	981	982	983	984
985	986	987	988	989	990	991	992
993	994	995	996	997	998	999	1000

	1	2
1	2	3
2	3	4
3	4	5
4	5	6
5	6	7
6	7	8
7	8	9
8	9	10
9	10	11
10	11	12

	1	2	3	4
1	2	3	4	5
2	3	4	5	6
3	4	5	6	7
4	5	6	7	8
5	6	7	8	9
6	7	8	9	10
7	8	9	10	11
8	9	10	11	12
9	10	11	12	13
10	11	12	13	14

	1	2	3	4	5	6	7	8	9	10
1										
2										
3										
4										
5										
6										
7										
8										
9										
10										

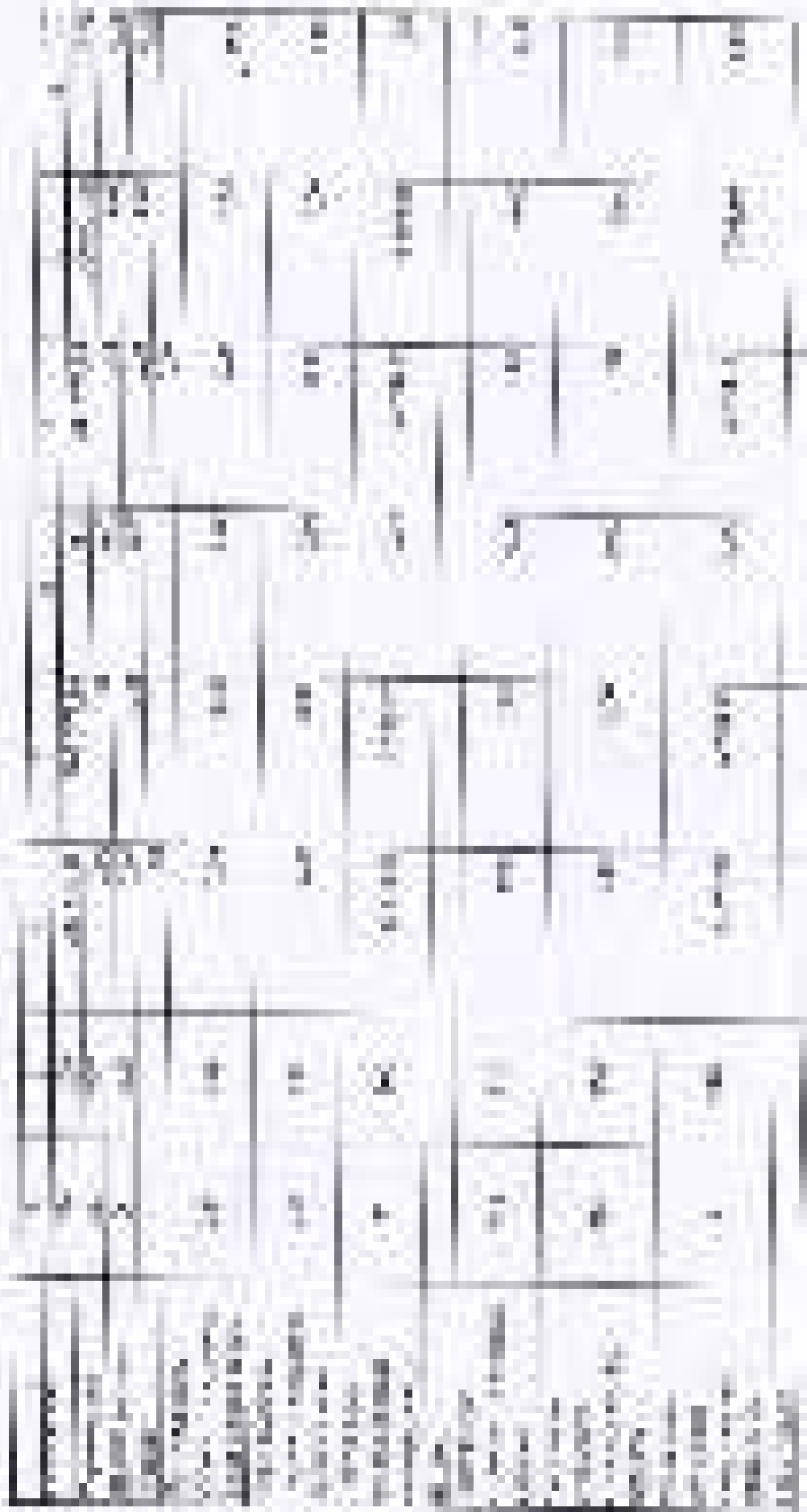

	1	2	3	4	5	6
1						
2						
3						
4						
5						
6						
7						
8						
9						
10						
11						
12						
13						
14						
15						
16						
17						
18						
19						
20						
21						
22						
23						
24						
25						
26						
27						
28						
29						
30						
31						
32						
33						
34						
35						
36						
37						
38						
39						
40						
41						
42						
43						
44						
45						
46						
47						
48						
49						
50						
51						
52						
53						
54						
55						
56						
57						
58						
59						
60						
61						
62						
63						
64						
65						
66						
67						
68						
69						
70						
71						
72						
73						
74						
75						
76						
77						
78						
79						
80						
81						
82						
83						
84						
85						
86						
87						
88						
89						
90						
91						
92						
93						
94						
95						
96						
97						
98						
99						
100						

1	2	3	4	5	6	7	8	9	10	11	12	13	14	15	16	17	18	19	20	21	22	23	24	25	26	27	28	29	30	31	32	33	34	35	36	37	38	39	40	41	42	43	44	45	46	47	48	49	50	51	52	53	54	55	56	57	58	59	60	61	62	63	64	65	66	67	68	69	70	71	72	73	74	75	76	77	78	79	80	81	82	83	84	85	86	87	88	89	90	91	92	93	94	95	96	97	98	99	100
---	---	---	---	---	---	---	---	---	----	----	----	----	----	----	----	----	----	----	----	----	----	----	----	----	----	----	----	----	----	----	----	----	----	----	----	----	----	----	----	----	----	----	----	----	----	----	----	----	----	----	----	----	----	----	----	----	----	----	----	----	----	----	----	----	----	----	----	----	----	----	----	----	----	----	----	----	----	----	----	----	----	----	----	----	----	----	----	----	----	----	----	----	----	----	----	----	----	----	-----

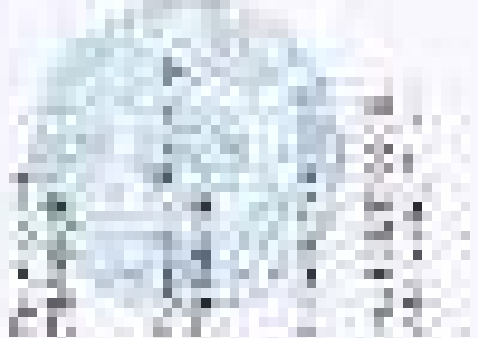

No.	Description of Work	Unit	Rate	Quantity	Amount	Total
1	Excavation and backfilling of foundation	m ³	100	100	100	100
2	Formwork for concrete slab	m ²	150	150	150	150
3	Reinforcement for concrete slab	kg	200	200	200	200
4	Concrete slab	m ³	100	100	100	100
5	Formwork for concrete wall	m ²	200	200	200	200
6	Reinforcement for concrete wall	kg	300	300	300	300
7	Concrete wall	m ³	100	100	100	100
8	Formwork for concrete column	m ²	100	100	100	100
9	Reinforcement for concrete column	kg	150	150	150	150
10	Concrete column	m ³	50	50	50	50
11	Formwork for concrete beam	m ²	100	100	100	100
12	Reinforcement for concrete beam	kg	100	100	100	100
13	Concrete beam	m ³	50	50	50	50
14	Formwork for concrete floor	m ²	100	100	100	100
15	Reinforcement for concrete floor	kg	200	200	200	200
16	Concrete floor	m ³	100	100	100	100
17	Formwork for concrete roof	m ²	100	100	100	100
18	Reinforcement for concrete roof	kg	200	200	200	200
19	Concrete roof	m ³	100	100	100	100
20	Formwork for concrete staircase	m ²	100	100	100	100
21	Reinforcement for concrete staircase	kg	150	150	150	150
22	Concrete staircase	m ³	50	50	50	50

	1	2	3	4	5	6	7	8	9
1	1	2	3	4	5	6	7	8	9
2	2	4	6	8	10	12	14	16	18
3	3	6	9	12	15	18	21	24	27
4	4	8	12	16	20	24	28	32	36
5	5	10	15	20	25	30	35	40	45
6	6	12	18	24	30	36	42	48	54
7	7	14	21	28	35	42	49	56	63
8	8	16	24	32	40	48	56	64	72
9	9	18	27	36	45	54	63	72	81

1	2	3	4	5	6	7	8
9	10	11	12	13	14	15	16
17	18	19	20	21	22	23	24
25	26	27	28	29	30	31	32
33	34	35	36	37	38	39	40
41	42	43	44	45	46	47	48
49	50	51	52	53	54	55	56
57	58	59	60	61	62	63	64
65	66	67	68	69	70	71	72
73	74	75	76	77	78	79	80
81	82	83	84	85	86	87	88
89	90	91	92	93	94	95	96
97	98	99	100	101	102	103	104
105	106	107	108	109	110	111	112
113	114	115	116	117	118	119	120
121	122	123	124	125	126	127	128
129	130	131	132	133	134	135	136
137	138	139	140	141	142	143	144
145	146	147	148	149	150	151	152
153	154	155	156	157	158	159	160
161	162	163	164	165	166	167	168
169	170	171	172	173	174	175	176
177	178	179	180	181	182	183	184
185	186	187	188	189	190	191	192
193	194	195	196	197	198	199	200

No	Date	Particulars	Debit	Credit	Balance	2019			
						Jan	Feb	Mar	Total
		Balance b/d							
		By Cash							
		To Cash							
		Balance c/d							
					Total				
		Balance b/d							
		By Cash							
		To Cash							
		Balance c/d							
					Total				

	1	2	3	4	5
1	1	2	3	4	5
2	2	1	4	3	5
3	3	4	1	2	5
4	4	3	2	1	5
5	5	5	5	5	5

1	2	3	4
5	6	7	8
9	10	11	12
13	14	15	16

17	18	19	20
21	22	23	24
25	26	27	28
29	30	31	32

33	34	35	36
37	38	39	40
41	42	43	44
45	46	47	48

1. $1 + 2 + 3 + \dots + n = \frac{n(n+1)}{2}$
 2. $1^2 + 2^2 + 3^2 + \dots + n^2 = \frac{n(n+1)(2n+1)}{6}$
 3. $1^3 + 2^3 + 3^3 + \dots + n^3 = \left(\frac{n(n+1)}{2}\right)^2$

4. $1 + 2 + 3 + \dots + n = \frac{n(n+1)}{2}$
 5. $1^2 + 2^2 + 3^2 + \dots + n^2 = \frac{n(n+1)(2n+1)}{6}$
 6. $1^3 + 2^3 + 3^3 + \dots + n^3 = \left(\frac{n(n+1)}{2}\right)^2$

11

12

13